

Blueprint

KANSAS CITY
PUBLIC SCHOOLS 2030

Phase 4: Recommendations

How Do We Get There?



KCPS Academic Vision

Connected, Empowered and
Liberated:

Every Child, Every Educator,
Every Family, Every Day!



Culturally Responsive Teaching

Culturally Responsive Teaching is a research-based approach to teaching. It connects students' cultures, languages, and life experiences with what they learn in school. These connections help students access rigorous curriculum and develop higher-level academic skills.



Teaching & Learning Across KCPS

Culturally Responsive Teaching Framework

- **Awareness:** Learning about culture, cultural beliefs, and studying how the brain learns
- **Learning Partnerships:** Teachers partnering with diverse learners, building trust and rapport
- **Information Processing:** Expanding students' intellectual capacity (increased brain power) so they can engage in deeper, more complex learning
- **Community Building:** creating supportive, welcoming and safe environments / student voice and agency

- *Many KCPS students are members of marginalized groups who are often underserved and historically, have underperformed academically.*
 - 90% students of color
 - 24% students learning English as a second language
 - 12% students on Individualized Education Plan (IEP)
 - 89% students qualify for free or reduced lunch

Teaching & Learning Across KCPS

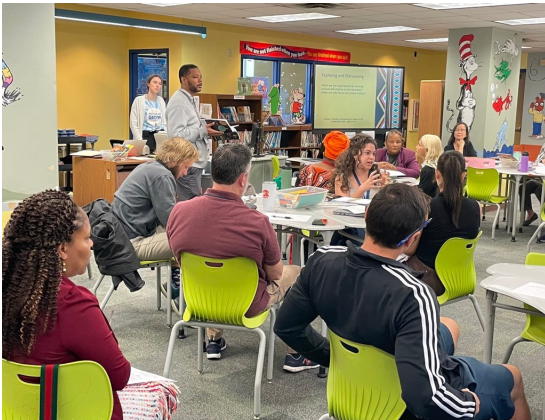

Culturally Responsive Practices

- District-wide Culturally Responsive Teaching Book Study
- Curriculum Audit – ForwardED
- Culturally Responsive Classroom Libraries
- Culturally Responsive Leadership Training: The Leadership Academy



Teaching & Learning Across KCPS



Literacy Strategies (Reading/Writing)

- **Academic Language and Vocabulary:** The language specific to the content area and key words that support comprehension and understanding
- **Close Reading:** Students will be able to extract meaning from text by examining how the language is used in a passage.

Math Strategies

- **Literacy in Math (K-12)** - integrating literacy into math using math stories, emphasis on mathematical vocabulary, and opportunities for writing.

Teaching & Learning Across KCPS



Reading & Math Endorsements Professional Learning Tracks

- PK LETRS Early Childhood
- K-3 LETRS Training (Language Essentials for Teachers of Reading and Spelling)
- NUMBERS Training - interactive, hands-on mathematics professional development
- 4-12 3L's Training (Learning, Language and Literacy)



Teaching & Learning Across KCPS



Project-Based Learning

- Students actively engaging in real-world and personally meaningful projects.
- PBL blends content mastery, meaningful work, and personal connection to create powerful learning experiences, in terms of both academic achievement and students' personal growth.

Teaching & Learning Across KCPS



Beyond the 4 Walls (Field Trips)

- Guaranteed real-world learning experiences outside of the classroom for every KCPS student.
- Targeted experiences aligned to the grade level curriculum and college and career pathways:
 - Deanna Rose (K)
 - Missouri State Capital (5th)
 - Washington DC - Capitol Hill, Smithsonian National Mall of Museums (8th)
 - Brown vs. Board of Education Museum in Topeka, KS (High School)

Elementary Experience



Elementary Science Labs

- Science labs in all elementary schools
- Dedicated lab technician to provide hands-on laboratory experiences for students in collaboration with the classroom teacher



World Language Classrooms

- Incorporating World Language across all elementary school sites beginning at kindergarten

Elementary Experience



Instrumental Music

- Instrumental music expansion of strings and winds to all elementary schools
- Providing exposure and experiences with instrumental music beginning at kindergarten

STEAM (Science, Technology, Engineering, Arts, and Math)

- Dedicated space for science and engineering activities and projects
- LEGO League, Robotics, Math Olympians that support technology, engineering and mathematics in all elementary schools
- Incorporation of Virtual Reality and Artificial Intelligence in classroom instruction
- All students will participate in digital, instrumental and performing arts starting in kindergarten
- Beyond the classroom, both scientists and engineers use models including sketches, diagrams, mathematical relationships, simulations and physical models — to make predictions about the likely behavior of a system

Secondary Experience



College and Career Pathways

- In each high school, students explore a four-year course of study, or “pathway,” designed to prepare students for future college or career success based on their industry of interest.
- All schools will have two common pathways across the district. A third pathway will be unique to the school’s community of learners.

Instrumental Music

- Marching Bands at all secondary schools

Secondary Experience



World Language Expansion

- Incorporating additional languages across all secondary school sites.

Competency-Based Learning

- Students are empowered daily to make decisions about their own learning
- Assessment is a meaningful, positive and empowering experience that informs learning

Align Grade Configurations



Elementary Schools

- Pre Kindergarten-5th Grade
- Pre Kindergarten-8th Grade

Middle Schools

- 6th Grade-8th Grade

High Schools

- 9th-12th Grade

SY 2023 Pilot Programs

- **World Languages - Spanish (Elementary)**
- **Fine Arts Expansion (Elementary & Secondary)**
- **Performing Arts (Elementary) Strings & Band**
- **Science Labs (Elementary)**
- **Music & Art Therapy Programs (Elementary)**
- **Competency-Based Learning (Secondary)**
- **Peer Collaboration Lead Teachers (Elementary)**



Proposed Phases of Implementation

Phase 1 (SY23 and SY24)	Phase 2 (SY25 and SY26)	Phase 3 (SY27)
<p><u>School Year 2022-23</u></p> <ul style="list-style-type: none"> • Culturally Responsive Teaching • Literacy Strategies (reading/writing) • Math Focus/ Strategies • Instrumental Music (secondary schools) • Reading & Math Endorsements <p><u>School Year 2023-24</u></p> <ul style="list-style-type: none"> • Instrumental Music (elementary schools) • Project-based Learning (all schools) • Beyond the 4 Walls (all schools) 	<p><u>School Year 2024-25</u></p> <ul style="list-style-type: none"> • K-2nd Grade Teachers (reading endorsements) • Science Labs (elementary) • Align Grade Configurations (PK-5, PK-8, 6-8, 9-12) <p><u>School Year 2025-26</u></p> <ul style="list-style-type: none"> • STEAM (elementary) • Competency-based Learning (high schools) • Foreign Language classrooms (elementary) • Foreign Language Expansion (secondary) • College and Career Pathways (secondary) 	<ul style="list-style-type: none"> • Evaluation/Assessment of Programming • Adjustments (based on data) <p>Implementation is contingent upon redirecting \$13.2M from Operations to the Academic Vision</p>

Facilities that Support the Academic Vision

SENSE OF PLACE



MULTIPLE LEVELS OF ENGAGEMENT



UNDER UTILIZED SPACES



ADAPTABLE SPACES



INNOVATION LABS



PROJECT-BASED EXPLORATION

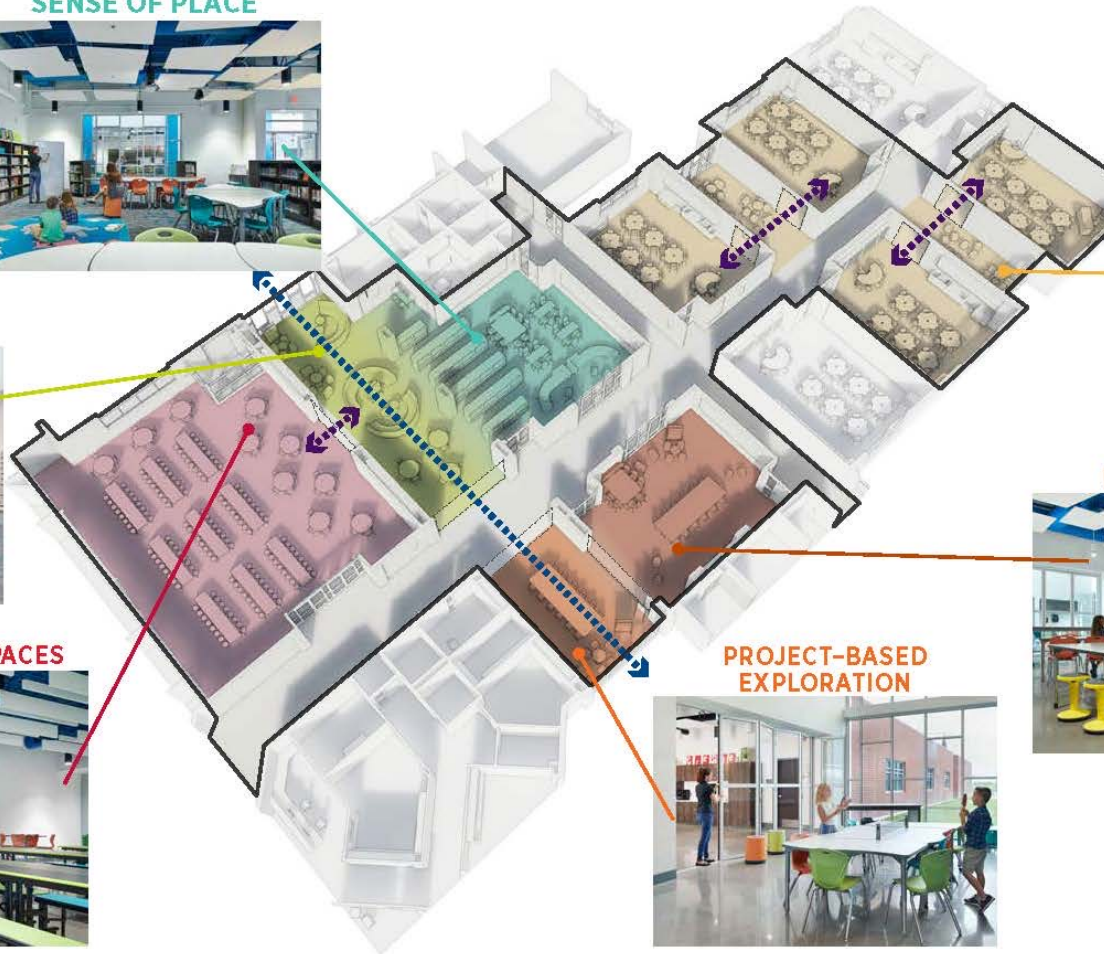

It is our time! Dare to Believe!

The Future of Our Facilities:
 New Construction
 Major Building Renovations
 Building Expansions/Replacements

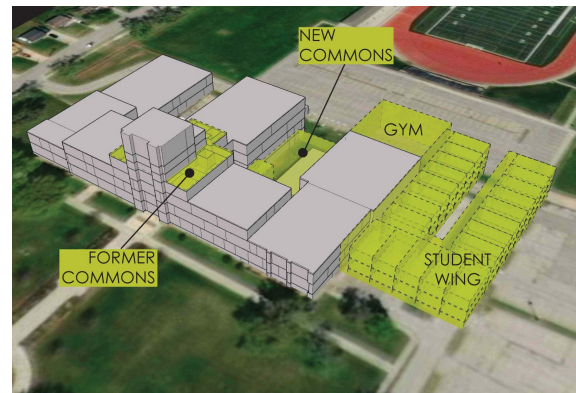
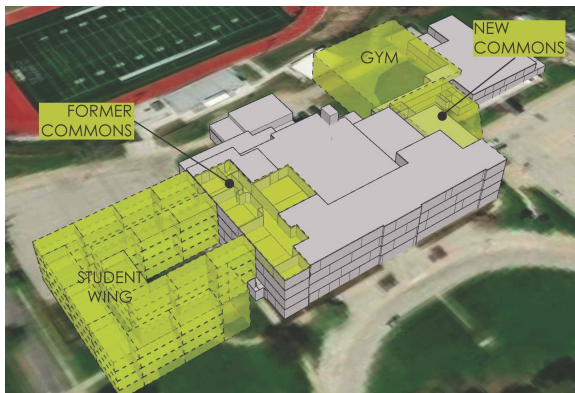

KANSAS CITY PUBLIC SCHOOLS **ACI EDWARDS ARCHITECTS**

ELEMENTARY TRANSFORMATION

REPURPOSING AUDITORIUMS

- SLOPED FLOORS BUILT IN SEATING, ELEVATED STAGE
- REMOVE SEATING AND FLOORING
- CONSTRUCT LEVEL FLOOR

- SMALL COLLABORATION ROOM WITH GLASS FRONT 300 SF.
- SCIENCE LAB WITH FLEXIBLE WALL 1,100 SF.
- ART LAB WITH FLEXIBLE WALL 1,100 SF.
- OPEN LARGE COLLABORATION AREA

- GRADE LEVEL CLASSROOM WITH FLEXIBLE WALL AT CORRIDOR 800 SF.
- SMALL OPEN COLLABORATION SPACE
- SMALL COLLABORATION ROOM WITH GLASS FRONT FACING CORRIDOR 300 SF.
- COMMON COLLABORATION POD WITH SMALL TIERED SEATING AREA

- CLASSROOM WITH FLEXIBLE WALL 475 SF.
- COMMON COLLABORATION AREAS WITH TIERED SEATING
- OPEN LARGE COLLABORATION AREA

NEW TYPES OF SPACES

- LIMITED RENOVATION: IMPROVE USE OF EXISTING WALLS AND CEILING TO ENHANCE SPACES.
- LEARNING ENVIRONMENT OPTIONS: REMOVE WALLS TO OPEN UP SPACE AND CREATE COLLABORATIVE LEARNING ENVIRONMENT.

- GRADE LEVEL EXPLORATION

- SMALL GROUP PODS:
 - SMALL GROUP PODS
 - SMALL GROUP PODS
 - SMALL GROUP PODS
 - SMALL GROUP PODS

ENHANCING EXISTING SPACES

- INCREASE USAGE: REMOVE WALLS TO OPEN UP SPACE AND CREATE COLLABORATIVE LEARNING ENVIRONMENT.



QUESTIONS

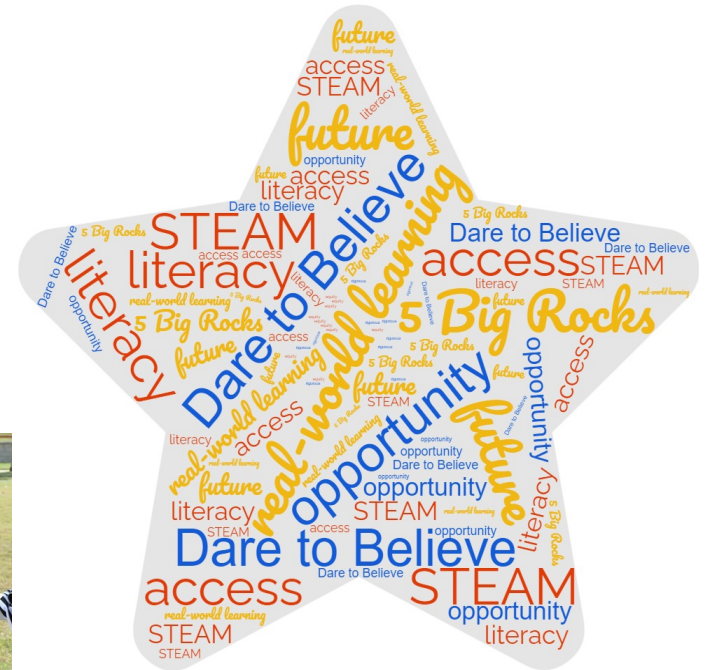



**Kansas City Public Schools
Blueprint 2030
Facilities Proposed Recommendations**

PUBLIC
SCHOOLS



MGT Capabilities

We stand on the front line for education, helping develop effective and efficient solutions – both from student outcomes and operations perspectives. We are school people helping school people. We've been there.

Academic

- Community Collaboration
- Demographic Studies
- Enrollment Projections
- Educational Technology Consulting

Facilities

- Facility Master Planning
- Fiscal Impact Studies and Models

Operations

- Operational Reviews
- Performance Assessment
- Needs Assessment
- Program Evaluation
- Strategic Planning

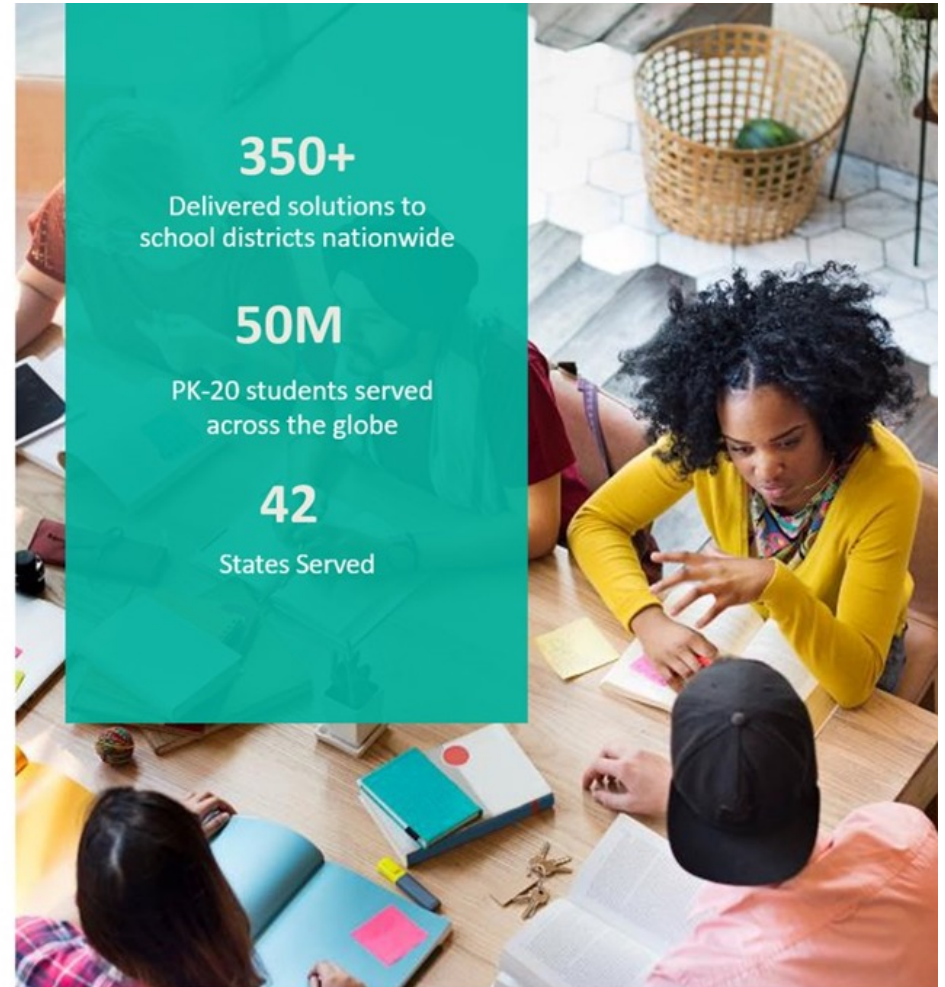

Our Experience

Danville Public Schools, Virginia	Fairfax County Public Schools, Virginia	Manassas City Public Schools, Virginia
Hamilton County Schools, Tennessee	Metro Nashville Public Schools, Tennessee	Aurora Public Schools, Colorado
Fairfield Public Schools, Connecticut	St. Louis Public Schools, Missouri	Kansas City Schools, Missouri
Anne Arundel County Schools, Maryland	Montgomery County Public Schools, Maryland	Kent School District, Washington
Hickman Schools, Missouri	Springfield Public Schools, Missouri	Wentzville School District, Missouri





Proposed Blueprint 2030 Scenario High Level Summary

- ✓ 27 of the 37 currently operating KCPS schools are recommended for continuation
- ✓ 10 currently operating schools are recommended for closure and/or conversion
 - ✓ 6 to become repurposed sites
 - ✓ 4 for KCPS use (1 for a MS, 3 for other)
- ✓ 2 schools are recommended for establishment/creation (1 renovation, 1 new)





Priority factors for facility recommendations

- ✓ Enrollment, recruitment, & retention
- ✓ Equity
- ✓ Projected future demographic trends
- ✓ Facility conditions / operational costs
- ✓ Geographic location
- ✓ Academic performance



Summary

Continuation



Closure



Convert



Reopen/New



Kansas City Public Schools SY 2020

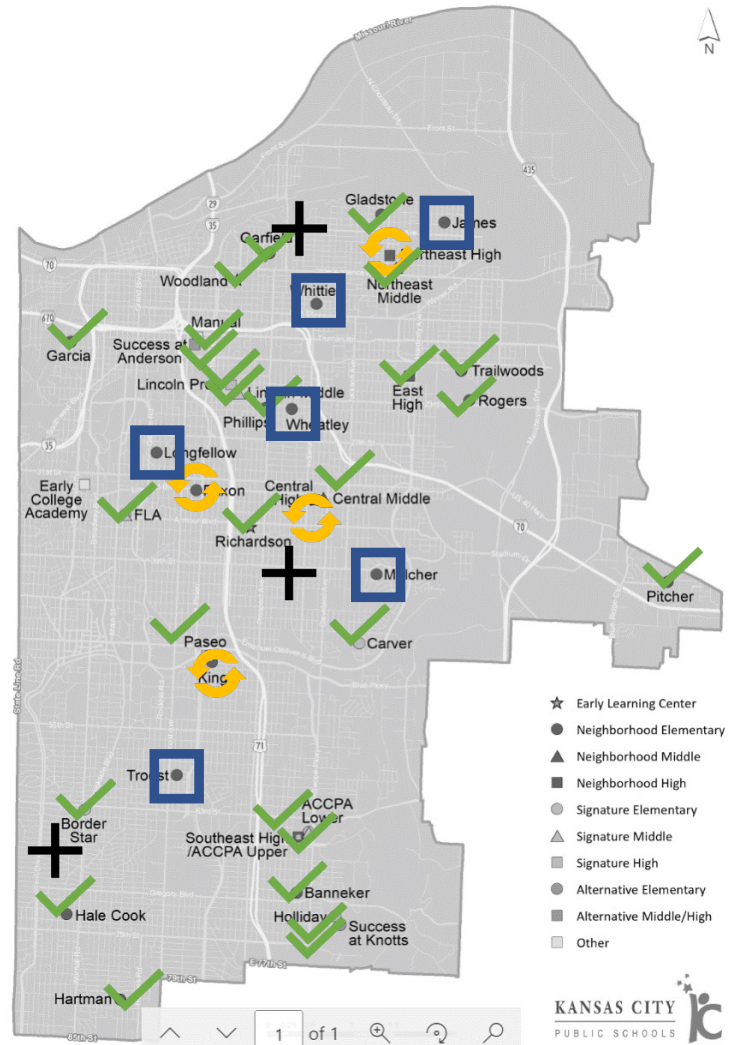

Schools Recommended for Continuation

Kansas City Public Schools
SY 2020



Count	School Name	Recommendation
1	East High	Continuation
2	Lincoln Prep Academy	Continuation
3	Paseo Academy	Continuation
4	Southeast High	Continuation
5	Success Academy at Anderson	Continuation
6	Central Middle	Continuation
7	Lincoln Middle	Continuation
8	Northeast Middle	Continuation
9	AC Elementary	Continuation
10	Banneker Elementary	Continuation
11	Border Star Montessori	Continuation
12	Carver Dual Language	Continuation
13	Foreign Language Academy	Continuation
14	Garcia Elementary	Continuation
15	Garfield Elementary	Continuation
16	Gladstone Elementary	Continuation
17	Hale Cook Elementary	Continuation
18	Hartman Elementary	Continuation
19	Holliday Montessori	Continuation
20	Phillips Elementary	Continuation
21	Pitcher Elementary	Continuation
22	Rogers Elementary	Continuation
23	Success Academy at Knotts	Continuation
24	Trailwoods Elementary	Continuation
25	Manual Career & Tech	Continuation
26	Richardson	Continuation
27	Woodland	Continuation

- ✓ 5 High Schools
- ✓ 3 Middle Schools
- ✓ 16 Elementary Schools
- ✓ 1 Career Center
- ✓ 2 Early Learning Centers



Schools Recommended for Creation/Establishment

Kansas City Public Schools
SY 2020

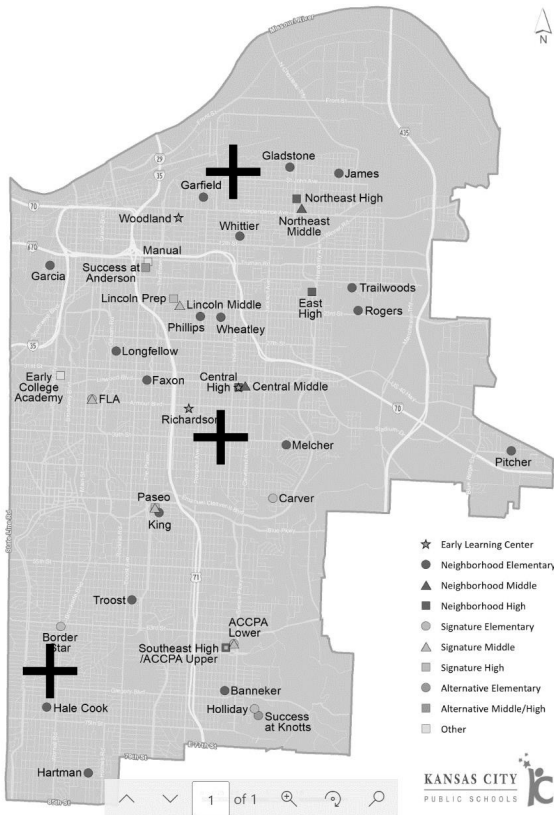

Count	School Name	Recommendation
1	South Middle School*	Remodel or New Construction
2	"New" King Elementary School*	New Construction
--	New Elementary/Replacement in the Northeast*	New Construction/Expansion

- ✓ 1 Middle School
- ✓ 2 Elementary Schools (1 new school, 1 replacement)

"New" King Elementary would house students from King, Faxon and Melcher

New Elementary/Replacement in the Northeast would replace an existing elementary school

*Contingent upon bond passage or securing other funding



Schools Recommended for Closure and/or Conversion

Kansas City Public Schools
SY 2020

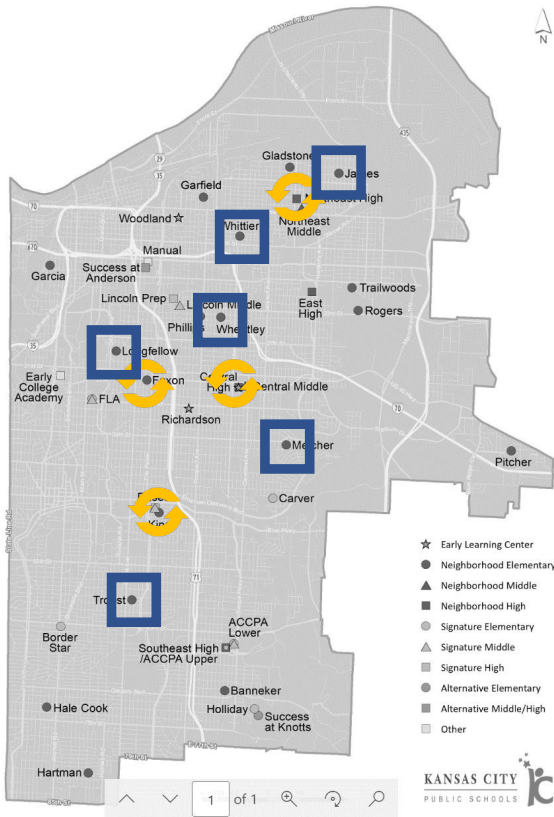

Count	School Name	Recommendation
1	Central High	Conversion/KCPS Use
2	Northeast High*	Conversion/KCPS Use
3	Faxon Elementary*	Conversion/KCPS Use
4	James Elementary	Repurposing
5	King Elementary	Conversion/KCPS Use
6	Longfellow Elementary	Repurposing
7	Melcher Elementary*	Repurposing
8	Troost Elementary	Repurposing
9	Wheatley Elementary	Repurposing
10	Whittier Elementary	Repurposing

- ✓ 2 High Schools
- ✓ 8 Elementary Schools

*Contingent upon bond passage



Conversion/KCPS Use Plans & Possibilities

Kansas City Public Schools
SY 2020

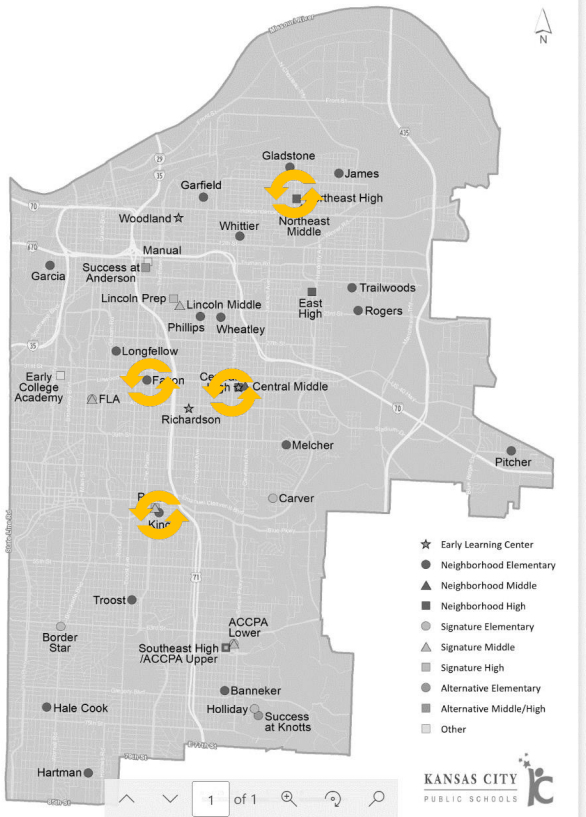

Central High

Professional Learning Center
Possible swing site for building relocations during renovations/construction
Other KCPS use TBD

Northeast High*

Swing site for building relocations during renovation/construction
Other KCPS use TBD

Faxon Elementary*

Possible relocation for Success Academy K-5
Possible Parent Empowerment Center

King Elementary

New home of Paseo Middle

*Contingent upon bond passage



Sample of Factors for Closure and/or Conversion

	Central High	Faxon	James	King	Longfellow	Melcher	Northeast High	Troost	Wheatley	Whitter
Academics (APR)	25%	67.10%	85.70%	47.10%	49.30%	75.00%	32.40%	24.30%	38.60%	82.10%
Enrollment	472	285	236	360	235	310	605	252	358	346
Five Year Enrollment Trend	-29	-17	-73	-48	-25	-53	-60	-119	-62	-114
Building Score	6.91	5.55	5.43	7.14	3.74	3.91	5.31	5.82	5.53	5.3
Total Deferred Maint. Cost	\$14.44M	\$2.75M	\$4.37M	\$3.77M	\$6.55M	\$5.64M	\$6.16M	\$4.33M	\$8.17M	\$6.28M
2030 Projected Population Change	-4.60%	4.50%	-3.60%	-2%	4.50%	-4%	-2.60%	-2%	-1.20%	-1.20%



Phase I – School Year 23-24

Central High

Conversion/KCPS Use

Academics (APR): 25%

Enrollment: 472

Five Year Enrollment Trend: -29

Building Score: 6.91

Deferred Maintenance: \$14.4M

Rationale:

- District projections show a reduction in high school student enrollment, requiring fewer total high school facilities.
- Facility does not meet the current needs of the district and other High School facilities/sites are better positioned for potential future district growth.

Future Potential Use:

- Professional Learning Center
- Possible swing site for building relocations during renovations/construction

Students Transitioned To: Southeast High*

*Contingent upon boundary assignment and location of specialized programs/services



James Elementary

Repurposing

Academics (APR): 85.7%

Enrollment: 236

Five Year Enrollment Trend: -73

Building Score: 5.43

Deferred Maintenance: \$4.37M

Rationale:

- District projections show a reduction in elementary school student enrollment, requiring fewer total elementary school facilities.
- Facility is one of the oldest in the district. The school has strong academics but is small and has many functional challenges that impact educational suitability, including the cafeteria.
- James is near Gladstone Elementary, and all James Elementary students will relocate to Gladstone.

Future Use:

- Repurposing

Students Transitioned To: Gladstone*

*Contingent upon boundary assignment and location of specialized programs/services



Longfellow Elementary

Repurposing

Academics (APR): 49.3%

Enrollment: 235

Five Year Enrollment Trend: -25

Building Score: 3.74

Deferred Maintenance: \$6.55M

Rationale:

- District projections show a reduction in elementary school student enrollment, requiring fewer total elementary school facilities.
- The facility is underutilized and has high deferred maintenance for a building with lower capacity. Other elementary schools throughout the district are better positioned for potential future district growth.

Future Use:

- Repurposing

Students Transitioned To: Garcia, Hale Cook*

*Contingent upon boundary assignment and location of specialized programs/services



Troost Elementary

Repurposing

Academics (APR): 24.3%

Enrollment: 252

Five Year Enrollment Trend: -119

Building Score: 5.82

Deferred Maintenance: \$4.33M

Rationale:

- District projections show a reduction in elementary school student enrollment, requiring fewer total elementary school facilities.
- The facility is underutilized, classrooms are very small, and continues to decline in enrollment and student academic performance is low.

Future Use:

- Repurposing

Students Transitioned To: Hartman, Banneker*

*Contingent upon boundary assignment and location of specialized programs/services



Phase 2 – School Year 24-25

Whittier Elementary

Repurposing

Academics (APR): 82.1%

Enrollment: 346

Five Year Enrollment Trend: -114

Building Score: 5.3

Deferred Maintenance: \$6.28M

Rationale:

- District projections show a reduction in elementary school student enrollment, requiring fewer total elementary school facilities.
- Despite strong academic performance, Whittier is underutilized and has high levels of deferred maintenance. The educational suitability of Whittier is less than that of neighboring schools.

Future Use:

- Repurposing

Students Transitioned To: Phillips, Garfield, Rogers, Trailwoods*

*Contingent upon boundary assignment and location of specialized programs/services



Wheatley Elementary

Repurposing

Academics (APR): 38.6%

Enrollment: 358

Five Year Enrollment Trend: -62

Building Score: 5.53

Deferred Maintenance: \$8.17M

Rationale:

- District projections show a reduction in elementary school student enrollment, requiring fewer total elementary school facilities.
- The facility has very high deferred maintenance and is located approximately four blocks from another elementary school that was constructed in 1994, providing greater educational suitability to support student learning.

Future Use:

- Repurposing

Students Transitioned To: Phillips, Rogers*

*Contingent upon boundary assignment and location of specialized programs/services



King Elementary

Conversion/KCPS Use

Academics (APR): 47.1%

Enrollment: 360

Five Year Enrollment Trend: -48

Building Score: 7.14

Deferred Maintenance: \$3.77M

Rationale:

- King shares a campus site with Paseo Academy, a school that currently serves 7-12 grade students.
- The school has low academic performance and declining enrollment.
- Repurposing the current King Elementary would allow for the addition of a new middle school and dedicated high school and would allow for the first new elementary school since 1994.

Future Use:

- New home of Paseo Middle School

Students Transitioned To: Hartman, Faxon/New Construction King, Melcher/New Construction King*

*Contingent upon boundary assignment and location of specialized programs/services



Phase 3 – School Year 26-27

Northeast High

Conversion/KCPS Use

Academics (APR): 32.4%

Enrollment: 605

Five Year Enrollment Trend: -60

Building Score: 5.31

Deferred Maintenance: \$6.16M

Rationale:

- District projections show a reduction in high school student enrollment, requiring fewer total high school facilities.
- The facility is underutilized and continues to decline in enrollment and student academic performance is low.

Future Use:

- Swing site for building relocations during renovation/construction
- Other KCPS use TBD

Students Transitioned To: East (expanded), Southeast (expanded)*

*Contingent upon boundary assignment and location of specialized programs/services



Faxon Elementary

Conversion/KCPS Use

Academics (APR): 67.1%

Enrollment: 285

Five Year Enrollment Trend: -17

Building Score: 5.55

Deferred Maintenance: \$2.75M

Rationale:

- District projections show a reduction in elementary school student enrollment, requiring fewer total elementary school facilities.
- The facility is underutilized and continues to decline in enrollment and an unsatisfactory educational suitability building score.

Future Use:

- Possible relocation for Success Academy K-5
- Possible Parent Empowerment Center

Students Transitioned To: New Construction King*

*Contingent upon boundary assignment and location of specialized programs/services



Melcher Elementary

Repurposing

Academics (APR): 75.0%

Enrollment: 310

Five Year Enrollment Trend: -53

Building Score: 3.91

Deferred Maintenance: \$5.64M

Rationale:

- District projections show a reduction in elementary school student enrollment, requiring fewer total elementary school facilities.
- The school has high academic performance but declining enrollment.
- The facility is underutilized and has a high amount of deferred maintenance.

Future Use:

- Repurposing





Students Transitioned To: New Construction King*

*Contingent upon boundary assignment and location of specialized programs/services



Timeline

Timeline: Proposed Phased Implementation SY23-26

	2022 – 2023		2023 – 2024		2024 – 2025		2025 – 2026	
 Academic Vision	Implement Culturally Responsive Teaching, Literacy Strategies (Reading & Writing), Math Strategies, Instrumental Music (Secondary Schools), and Reading & Math Endorsement Professional Learning Tracks	Pilots evaluated	Implement Instrumental Music (Elementary Schools) and Beyond the 4 Walls (Field Trips)		Align Grade Configurations (PK-5, PK-8, 6-8, 9-12) Paseo adds World Language theme Open Family Empowerment Center Implement Project-Based Learning (All Schools) and Science labs (Elementary Schools)	Pilots evaluated	Implement STEAM and World Language Classrooms (Elementary Schools), Competency-Based Learning, World Language Expansion, College and Career Pathways (Secondary Schools)	Pilots evaluated
 Operation of Schools			Close Central, Longfellow, Troost, James		Open South Middle School Close King, Wheatley, Whittier Paseo becomes Grades 6 – 12 in High School Building		Renovated CTE Center Opens Former King becomes Paseo Middle Grades 6 – 8, Paseo High becomes Grades 9 – 12	
 Bond/Funding	Hire architect, start bond project planning, polling Secure external funding for CTE Center and South Middle School	Planning	Redirect \$6.7 M from Operation of Schools to Academic Vision Bond Planning	Bond #1 Vote (April 2024)	Redirect \$731,319 from Operation of Schools to Academic Vision			
 Construction/ Capital Improvements	Start design work for CTE Center and South Middle School			Finish South Middle School, start design work for Bond #1 Sites	Start construction at Bond #1 Site: King Elementary (New Construction) East High and Southeast High	Finish CTE Center		Finish construction at Bond #1 sites
	FALL	SPRING	FALL	SPRING	FALL	SPRING	FALL	SPRING



Timeline: Proposed Phased Implementation SY27-30

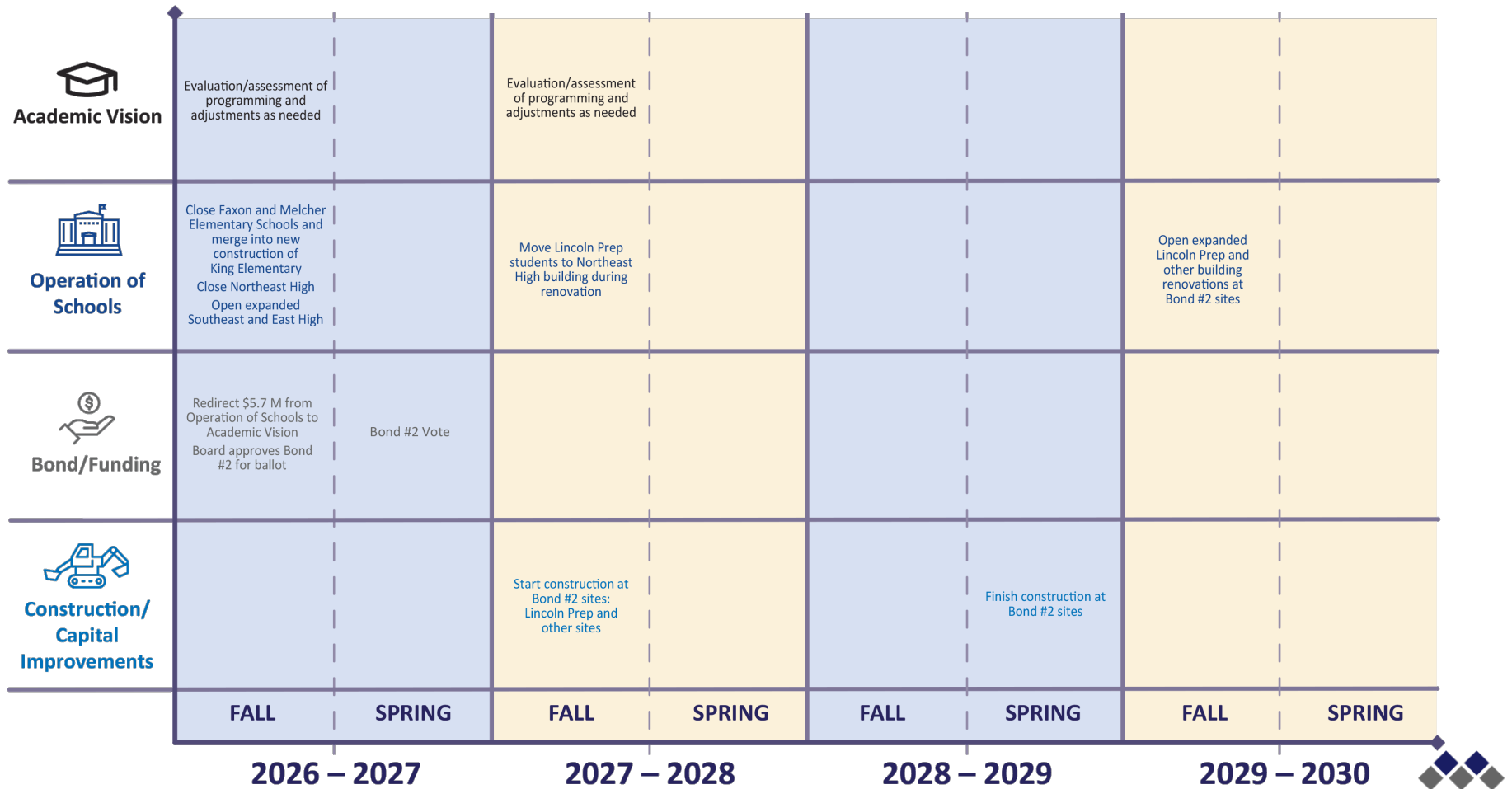

Benefits of Blueprint 2030 Implementation

- Redirect \$13.2M to Academic Vision investments
- Access to expanded and equitable learning opportunities
- Project-based learning will help students to make real world connections
- World Language exposure in elementary, expansion in secondary
- STEAM elementary schools
- Instrumental music in elementary and secondary schools
- Resources dedicated to field trips and outside of school experiences
- College and Career Pathways
- New or renovated facilities that support Academic Vision
- More clubs and activities
- Increased electives and offerings
- Fully staffed KCPS schools
- More supports in schools for students and staff

